

Benjamin

Huss

Chapter 16

Benjamin Huff



Benjamin Huff was born on 4 June 1815 in Addision Twp. of Somerset County, PA. His date of birth was passed down to the descendants of the Huff family with no documentary proof of birth, but the place of his birth was verified. The family lived in that part of Pennsylvania during the time of Benjamin's birth. The family lived in Turkey Foot Twp. of Bedford County between 1789 to 1795, and Somerset County between 1796 to 1825.

His Parents were Thomas Huff 3rd & Mary (Hiestand) Huff. It is not known if Benjamin Huff received formal education to learn to read and write. During this time in history the public schools were not established, but there were teachers that held private school classes, because there were school masters listed on the county tax lists. It is most likely our Huff ancestors could not afford to send their children to private school.

Some time in the year 1825 the family moved to Beaver Twp. of Pike County, Ohio. Benjamin had an older brother named Thomas Huff 4th, who arrived with his family around 1818 from Monagalia County VA (today it is in West VA). He had bought a 76 acre farm in Beaver Twp.

The U.S. Census for 1830 & 1840 did not list Thomas Huff 3rd as the head of a household, As he was living in a boarding house and did not show as the head of a household during these census reports. It seems the census takers did not list the people who lived in boarding houses.

Benjamin's father passed away in September 1841. His father left a will to settle his estate. Benjamin received an inheritance of \$1.00.

It is not known where Benjamin Huff lived after the death of his father until the 1850 U.S. census report for Beaver Twp. Pike County, Ohio. There has been a story handed down by the Huff descendants to George Wesley Huff 2nd, and it goes some thing like this.

In 1844 or 1845 Benjamin Huff joined a group of men that had permission from the state government to move some Indians who lived in the Ohio area to the Red Lake area in Minnesota. This job took these men most of the summer. As the story goes these men had a cannon with them. This cannon shot two cannon balls at the same time with a metal chain connected between them. Such a device was used on old naval sailing ships for the sole reason was to shoot at the enemy sailing ship, with the hope that the chain would snap the enemies mast in half. This would help to slow the enemy ship's movements. It is not known if these men ever used the cannon on the Indians, or just show the Indians how destructive this weapon was on a tree trunk. This would sure help keep the Indians in line through fear and prevent trying to escape from the white men. The story told about how these Indians were stealing the white man's crops, cattle, and personal property. As the story goes the Indians were making a nuisance of themselves.

This is an interesting story, but the family genealogist has been unable to find any history books to verify the story. A letter was sent to the Chillicothe Public Library, 140 South Paint Street, Chillicothe, OH 45601. They were unable to find any information to verify the story, but they suggested writing to the Waverly Public Library, Waverly, Ohio 45690. The Waverly library wrote back that they could not verify this story in any of their history books. There still may be some truth to this story. If it is true that Benjamin was with these men moving some Indians to the Red Lake area in Minnesota then these men had to travel through what was Allamakee County of today. This may have been what planted the idea in Benjamin's mind to move his family to Allamakee County, Iowa in 1856. Also William D. Callender and his wife Abigail Huff settled in Post Twp. Allamakee County, Iowa in 1847.

After 1845 it is not known where Benjamin lived in Beaver Twp. Pike County, Ohio. Benjamin may of been working for the David Rickenbach family, and may have lived with them. Benjamin Huff met Mary Rickenbach while he work for the Rickenbach family. They were married on 15 February 1847 in Pike County, OH. The marriage certificate is recorded at the probate court office. Clerk of Probate Judge, 100 E 2nd Street, Waverly, OH 45690-1399. David Rickenbach gave them a 40 acre farm as a wedding gift.

The 1850 U.S. Census Report listed Benjamin, Mary, John T., & Elizabeth Huff living on a farm in Beaver Twp., Pike County, OH. Benjamin was 35 so this meant he was born in 1815. Mary (Rickabaugh) Huff was around 21 years old, and she was born around the year of 1829. John T. Huff was 3 years old, and he was born on 28 March 1847. Elizabeth Huff was born on 26 May 1850. She was a month old when the census was taken.

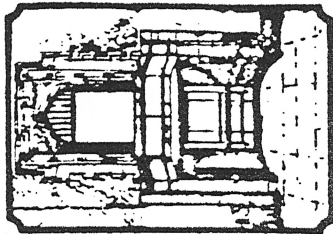

Chillicothe and Ross County Public Library

MEMO

TO:

Dale Miller

FROM:

Benjamin Huff

DATE:

4-7-81

* * * * *

*I could not find any reference to the 'Indian Cave'
or any of the names you are searching.
We do not have much info. with Pike Co. names. You
can write to the Pike County Free Public Library
111 North High St., Waverly OH 45690.*

P. O. BOX 185 • 140-146 SOUTH PAINT STREET • CHILLICOTHE, OHIO 45601 • TELEPHONE (614) 773-4145

Marriage License

Benjamin Huff	We the State of Ohio do hereby certify that on the 17 th day of Dec. 1847 Benjamin Huff and Mary Rickenbaugh were legally joined in marriage by me David Rickenbaugh
Doz Marriage Licence	
Mary Rickenbaugh	
February 15 th 1847	
David Rickenbaugh	

The Benjamin Huff farm was located in the SW 1/4 of the SW 1/4 of section 21, Twp. 6, Range 20 W. The directions for getting to this farm are given below.

Starting at Waverly, OH where you can buy a Pike County map at the Court House, drive south on U.S. 23 for 7 miles to the junction of Ohio 124 highway (hwy), and then East for 11 miles to junction Ohio 335 hwy. You will make a left turn onto hwy. 335, and drive North for 2 miles which comes to the junction of Beaver Pike. This junction is located at the western edge of the town of Beaver, Ohio. Turn to the left onto Beaver Pike and drive about 2 miles West to the junction of Buck Hollow Road. Drive northward for about 1 3/4 miles on paved road to the junction of Ervin Hill Twp. road to the left and the Buck Hollow Twp. road to the right. You will drive on the unpaved Buck Hollow Twp. road that makes an uphill climb for about 1/2 mile where you will come to a farm house on the right side of the road, and a small barn or a garage on the left side of the road.

The topographical features of the land are as follows.

Just behind the wooden house the land is formed into a steep hill. To the West and the South the features make up a gradual down hill incline, and this land can be farmed.

The general topographical features of southern Ohio are made up of rolling hills and valleys. These rolling hills and valleys were formed by one of the continental glacial ice period. One of these glacial periods was call the Kansan Glacier Periods. The glacial period began over 300,000 years ago. This large glacier covered a large area of the North America continent. It covered most of Canada and many parts of the norther U.S.A. The glacier dumped large amounts of rock and dirt that made up the rolling hills in southern Ohio. A drawing of the Pleistocene Great Glacier has been placed in this text.

On 27 June 1856 Benjamin and Mary Huff sold their 40 acre farm to Mary's father, David Rickenbach, for \$280.00, and moved to Allamakee County Iowa.

Benjamin & Mary (Rickenbach) Huff Children In 1856:

Name	Date of Birth	Age in 1856
1. John Thomas Huff	28 March 1847	9
2. Elizabeth Huff	26 May 1850	6

- | | | | |
|----|----------------|-----------------|----|
| 3. | Eliza Ann Huff | 1853 | 3 |
| 4. | Susan A. Huff | 24 January 1856 | <1 |

George Wesley Huff 2nd has passed down the story how the family moved to Allamakee County, Iowa. The story goes something like this.

Mary (Rickenbach) Huff and her 4 children rode on the New York Central Railroad to the most northern end of the tract where Mary and the children waited for Benjamin to catch up by driving his wagon team in a wagon train at a much slower pace. Benjamin finally arrived at the end of the tracts where the family was reunited again. The family made the rest of the trip riding on the wagon to Allamakee County, Iowa where they settled in Post Twp. near Postville, Iowa. Post Township was organized in 1851, which was 5 years before Benjamin & Mary Huff moved there.

The 1860 & 1870 U.S. Census listed the family living in Post Twp. These reports list their post office as the town of Hardin which was located mostly in Clayton County. The two counties meet on Allamakee County's southern border. The most northern tip of Hardin projected into the southwestern corner of Franklin Twp. of Allamakee County. Franklin Twp. is the next eastern township of Post Township. The town of Hardin no longer exists in eastern Iowa. So Benjamin & Mary Huff most likely lived within the southeastern quarter of Post Township.

Allamakee County has many rolling hills and valleys which were also formed by the Kansan glacial period. Many of the hills are covered with woodland, and the valleys are farmed. John Howe of Charles City, Iowa, a good friend of John Thomas Huff, asked him one time why his father went to live in Allamakee County rather than go to live in Chickasaw County which has fairly flat farming land. Well, John T. Huff's answer to this question was as follows: His father, Benjamin Huff, picked Allamakee County, because there was more woodland along with the farm land. The point to be brought out is the old timers look at the woodland as being an important natural resource to own because some of the family needs could be made out of wood. The German people who have lived in Europe learned at a very early time in their history that trees are very valuable to their way of life. The Germans set up conservation programs at a early time in their history and plant 6 young trees in the place of every older tree that was removed from their woodland. The German people farmed the valleys and preserved the woodland on the hilly land. These programs are still put into practice today in Germany.

From colonial days up to the 1840s most of the U.S. farmers were practicing subsistence farming except for the Southern

Deed Vol 14 page 545

Benjamin Huff & wife }
 David Rickenbach }
 Know all men by these presents that
 we Benjamin Huff and Mary Huff
 his wife of the County of Pike and State of
 Ohio in consideration of the sum of two
 Hundred dollars and Eighty Dollars in hand paid by
 David Rickenbach of the same place here bargained and
 sold and do hereby bargain sell and convey unto the said
 David Rickenbach his heirs and assigns forever the following
 premises situate in the County of Pike and State of Ohio and
 in the district of Lands sold at Leitchville Ohio and bounded
 and described as follows it being the South West Quarter of the
 North West Quarter of Section No Twenty one in Township six
 of Range twenty containing Forty acres more or less to have
 and to hold said premises with the appurtenances unto
 the said David Rickenbach his heirs and assigns forever
 and the said Benjamin Huff for himself and heirs doth
 hereby warrant with the said David Rickenbach his heirs &
 assigns that he is lawfully seized of the premises afore said
 that the premises are free and clear from all incumbrances
 what ever and that he will forever warrant and defend the same
 with the appurtenances unto the said David Rickenbach
 his heirs and assigns against the lawful claims of all
 persons whatsoever In testimony where of the said
 Benjamin Huff and Mary Huff have these unto set
 their hands and seals this 27th day of June A D 1856
 Signed in presence of us { Benjamin^{his} Huff
 Jacob^{his} Rickenbach { Recorded { Mary^{her} Huff
 Michael^{mark} Gall { Jan 19-1856 {

State of Ohio Pike County ss Before me Michael Gall a Justice
 of the Peace in and for said County personally appeared
 the within named Benjamin Huff and Mary Huff
 his wife and acknowledged the signing and sealing
 of the within Deed of Conveyance to be their voluntary
 act and deed and the said Mary Huff being at the
 same time examined by me separately and apart from
 her said husband and the contents of said instrument
 made known to her by me she the declared that she
 did voluntarily sign seal and acknowledge the same
 and that this is still satisfied there with Given under
 my hand and seal this 27 day of June A D 1856

Michael Gall J P

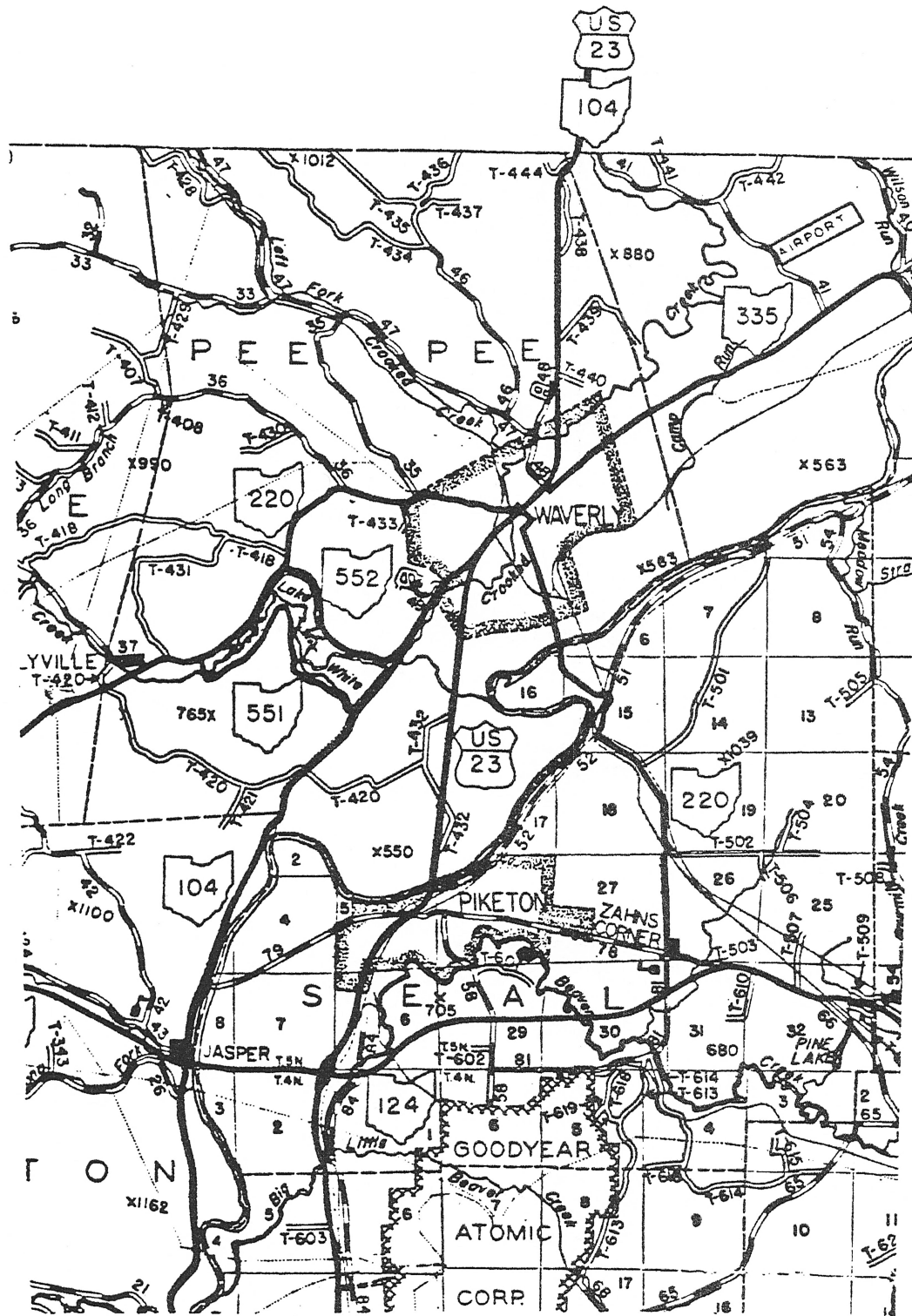

Part of Pike County, Ohio

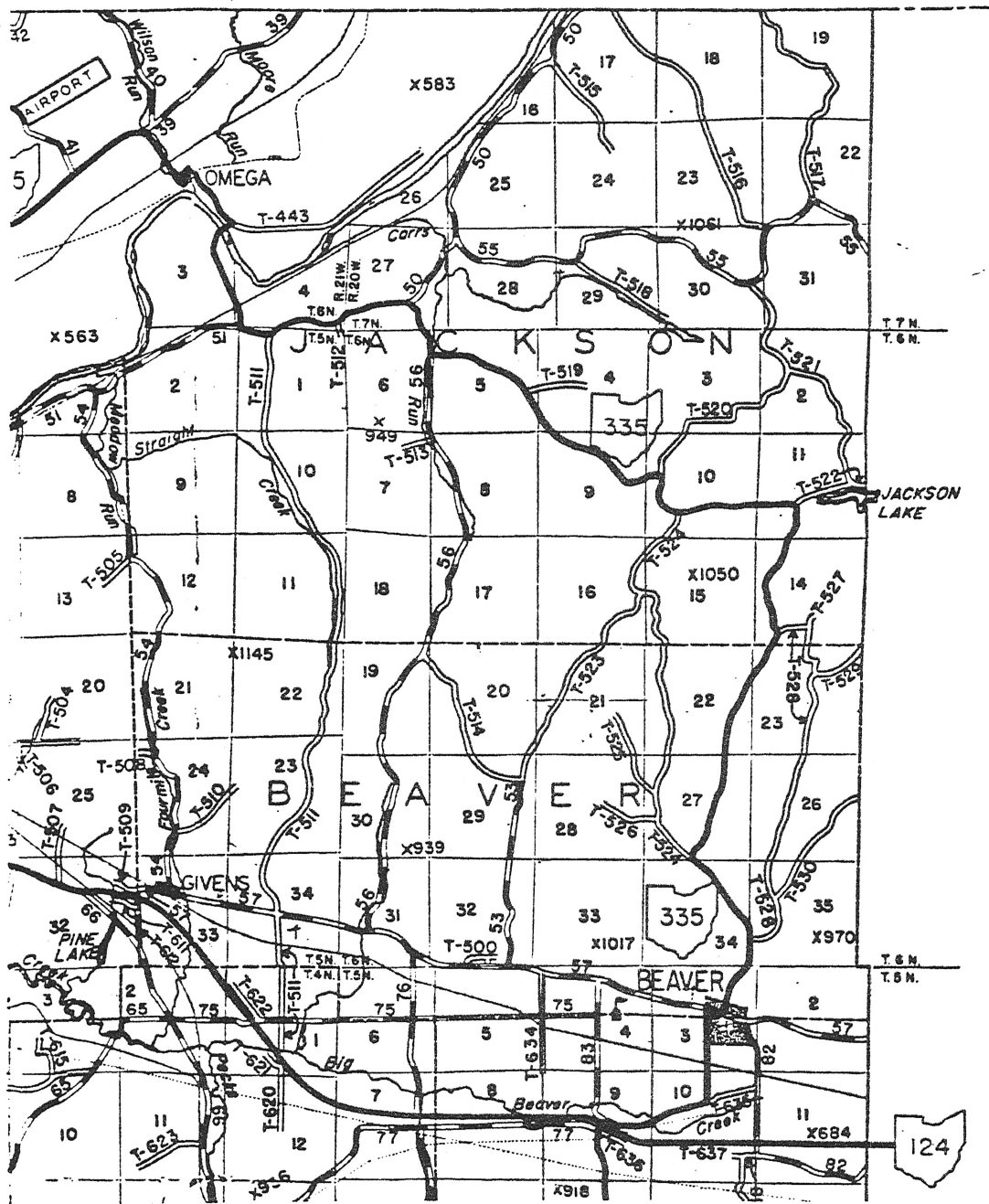

Part of Pike County, Ohio

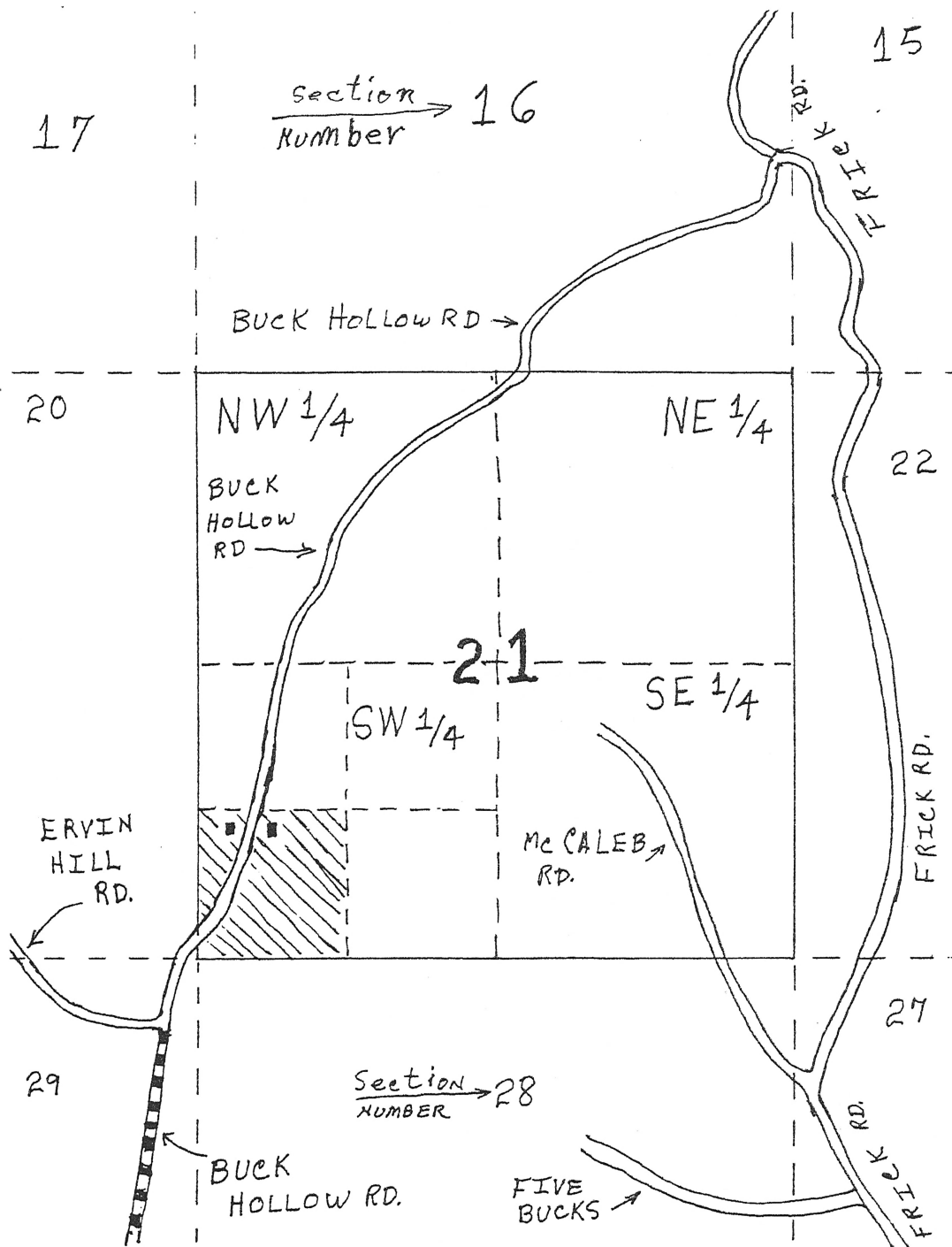

Huff Farm Pike Co. Ohio



Ohio

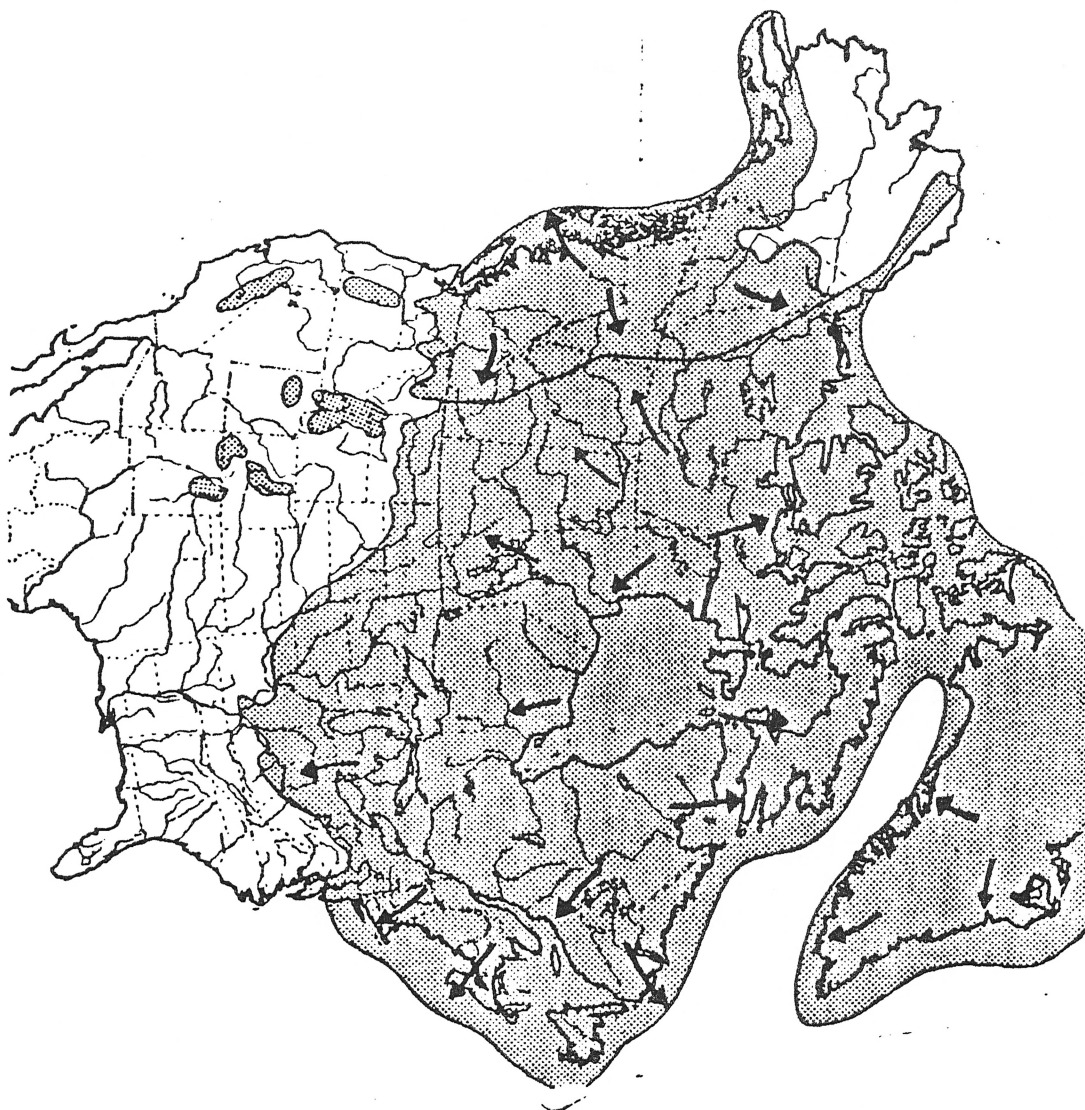

PLeistocene
Great Glacier

plantation cotton farmers who raised cotton as a cash crop with slave labor. Subsistence farming is where the farmer raised enough crops to feed his family and livestock, and usually none of his crops were sold at the market place. The subsistence farmer has no cash to buy manufactured products, and the family had to make their own clothes and products, tools, & other goods that were needed to run the family farm.

In the 1840s the railroads were being built in the eastern states and they were being started by the 1850's in the midwestern states. These railroads brought about the start of the American Industrial revolution. As early as 1847 industry introduced some farm machinery. All of the farmers were slowly being brought toward the American industrial age which was in full swing by 1885. Now more farm machinery was being produced in American factories, and sold to aggressive farmers. This action slowly changed the structure of the American farms. To be successful at farming now meant a farmer would have to own farm machinery and operate larger acreage farms to keep up with the rat race. The structure of the farm now no longer needed extra people to operate the farm, and this made the farmer independent since they only needed part time help during the busy seasons. This also raised the farmer's standard of living. American farmers could no longer return to the practice of subsistence farming because the standard of living would fall off very quickly. The American farmer was always in debt to the banker, because the farmer had to borrow the capital from the banks so they could buy the farm machinery and seed for the next years crops. The farmer was now locked into a financial and economical situation that would forever in trape him in this economical system, which had good and bad points of view among the American people. The farmer had to practice raising specialized cash crops that grew the best in their climate zone in order to maximize a profit for paying his outstanding loans at the banks.

There was a search made at the Allamakee County Court House at Waukon, IA to locate any wills, land deeds, and any other documents. The only document that found was the marriage record of George Wesley Huff 1st, was married to Cynthia Patterson on 20 December 1887 in Allamakee County. The 1860 & 1870 U.S. Census Report for Allamakee County, Iowa is the only other proof that the Benjamin Huff family lived in Post Township, and listed Benjamin working on a farm.

There were no land deeds located at the court house to show that Benjamin & Mary Huff owned any land in Post Township. It looks like Benjamin's dream of owning Iowa land never materialized because of the changing structure of the American farm. It looks like Benjamin & Mary were caught up in the changing times which they were helpless to do any thing about. Listed below are two theories why they may not have been prepared to cope with the changing times.

Theories About Benjamin Huff's Problems:

1. They did not have a formal education in the English or German language. They grew up in a period of American history where the family was settled in remote areas where schools were not available to the Huff family, and they could not afford to go to a private school.
2. It is most likely Benjamin & Mary could not read, write, or speak English to get by in their daily living. This put them at a great disadvantage where most of the people in Allamakee County spoke in the English language. By this time the English language was the established language in the United States.

Listed below are two factors that back up the above theories. .tc Factors That Back Up These Theories 16-#

27

1. When Benjamin & Mary sold their 40 acre farm on June 1856 in Pike County, Ohio, they did not write their signatures on the deed. They placed their marks on the deed. A copy of this deed has been placed in the text.
2. There has a been story passed down by the descendants of Benjamin Huff. George Wesley Huff 2nd passed the story down to his children Norma & Warren Huff, and on to the family genealogist. The story comes in the form of a statement: "Our grandmother Huff could not speak a word of English".

John Thomas Huff, his brother, and four sisters may have been the first generation of Huffs to receive a formal education in reading and writing in the English language. All previous generations may not have received any education to learn to read and write in German or English because public schools were not available during the colonial period or in early American history. The Huff family had always lived in or near a German settlement in the eastern states until the Huffs arrived in Allamakee County, Iowa.

After the family moved to Iowa, Benjamin & Mary had two more children added to the Huff family. Below is a list of Benjamin & Mary Huff's children.

Name	Date of Birth	Place Of Birth
1. John T. Huff	28 March 1847	Pike Co., OH
2. Elizabeth Huff	1850	Pike Co., OH
3. Eliza Ann Huff	1853	Pike Co., OH
4. Susan A. Huff	24 January 1856	Pike Co., OH
5. Abigail Huff	29 April 1858	Allamakee Co., IA.
6. George Wesley Huff 1st	1 February 1862	Allamakee Co., Iowa.

Benjamin & Mary had their hands full raising six children during the Civil & post- Civil War depression years with few years of prosperity in the 1860s.

In the 1860 U.S. Census Report of Post Twp. of Allamakee County, Iowa listed the following.

1. Benjamin Huff, age 45, sex male, farmer, born in Pennsylvania, and he was a person over 20 who could not read or write.
2. Mary Huff, age 23, sex female, home keeper.
3. Thomas Huff, age 11, sex male, born in Ohio, and attending school.
4. Elizabeth Huff, age 8, sex female, born in Ohio, and attending school.
5. Eliza Ann Huff, age 7, sex female, born in Ohio, and attending school.
6. Susan A. Huff, age 4, sex female, born in Ohio.
7. Abigail Huff, age 2, sex female, born in Iowa.

The 1870 U.S. Census Post Twp. Allamakee County, Iowa lists the following family members.

1. Benjamin Huff, age 54, sex male, works on farm, born in Virginia (which is incorrect because he was born in PA), he is over 20 years old and can not read or write English.
2. John Huff, age 22, sex male, at house, born in Ohio, and he is a U.S. citizen over 20 years old.
3. Eliza Ann Huff, age 18, sex female, at house, born in Ohio.
4. Susan A. Huff, age 14, sex female, at house, born in Ohio, attending school & can not write.
5. Abigail Huff, age 12, sex female, at house, born in Iowa, she is attending school, can not write.
6. George Wesley Huff, age 8, sex male, at house, born in IA, he is attending school, can not write.

The 1870 U.S. Census Report dose not list Mary (Rickenbach) Huff, so she most likely passed away between 1862 to 1870. Also Elizabeth Huff was not listed on this census report. She was either working for another family in the area or had married Jacob Bombar.

Benjamin Huff passed away some time around the year 1872 or 1873. The grave sites of Benjamin & Mary Huff have never been located in Post Twp. The descendants have tried to locate their grave sites, but they have never been found.

It has been passed down to the descendants that when John T. Huff was 25 years old, which was around 1872, he moved away from Allamakee County taking two of his younger sisters. The 1880 Iowa State Census of Coldwater Twp. of Butler County, Iowa list the following.

1. Thomas Huff, age 30, sex male, color white, birth place Ohio, occupation farmer. The name should be John Thomas Huff.
2. Susan Huff, age 23, sex female, color white, birth place Ohio, keeping house.
3. Abigail Huff, age 21. sex female, color white, birth place Iowa, keeping house.

Page No. 897

371

SCHEDULE 1.—Free Inhabitants in Post Township in the County of Allegheny State
 of Penn enumerated by me, on the 29th day of August 1880. James Palmer Asst Marshal
 Post Office Warden

Dwellings—house- numbered in the order of valuation.	Family numbered in the order of valuation.	The name of every person whose usual place of abode on the first day of June, 1880, was in this family.	Description.			Profession, Occupation, or Trade of each person, male and female, over 15 years of age.	Value of Estate Owned.		Place of Birth, Naming the State, Territory, or Country.	Married within the year.	Attended School within the year.			Whether deaf and dumb, blind, insane, idiotic, pauper, or convict.
			Sex.	Age.	Color, black, or mulatto.		Value of Real Estate.	Value of Personal Estate.						
1	2	3	4	5	6	7	8	9	10	11	12	13	14	
		Mary A. Wood	f	36		Housekeeper			Connecticut					
		Mary E.	f	19					N. Y.					
		Mary E.	f	17					do					
		William	m	42					Iowa					
		John Gray	m	74		Housekeeper			Ireland					
		Aldred C. Dummer	m	53		Housekeeper		200	N. Y.					Pauper
		Benjamin Huff	m	44		Housekeeper		100	P. A.					
		Mary	f	28		Housekeeper			Minnesota					
		Thomas	m	71					Ohio					
		Elizabeth	f	18					do					
		Elizabeth	f	7					do					
		William A.	m	2					do					
		Adriana	f	2					do					
		Edw. J. Huff	m	44		Housekeeper		2,500	do					

1860 U.S. CENSUS OF IOWA

Page No. 21

Enumerated by me on the 25 day of June, 1870.

in the County of Williams, State of Iowa.

Special Agent Marshal.

No.	Name	Sex	Age	Color	Profession, Occupation, or Trade of each person, male or female.	Value of Real Estate	Value of Personal Estate	Place of Birth, naming State or Territory of U.S. or the Country, if of foreign birth.	Particulars		If born within the year, give month (Jan., Feb., etc.)	If married within the year, give month (Jan., Feb., etc.)	Attended school within the year.	Can read.	Can write.	Whether deaf and dumb, insane, idiotic, pauper, or convict.	Remarks
									Father of family birth.	Mother of family birth.							
1	Benjamin Huff	M	34	W	Farmer			Iowa									
2	Mary Huff	F	32	W	Farmer			Iowa									
3	John Huff	M	12	W	School			Iowa									
4	William Huff	M	10	W	School			Iowa									
5	Elizabeth Huff	F	8	W	School			Iowa									
6	James Huff	M	6	W	School			Iowa									
7	John Huff	M	4	W	School			Iowa									
8	Mary Huff	F	3	W	School			Iowa									
9	John Huff	M	2	W	School			Iowa									
10	Mary Huff	F	1	W	School			Iowa									
11	John Huff	M	1	W	School			Iowa									
12	Mary Huff	F	1	W	School			Iowa									
13	John Huff	M	1	W	School			Iowa									
14	Mary Huff	F	1	W	School			Iowa									
15	John Huff	M	1	W	School			Iowa									
16	Mary Huff	F	1	W	School			Iowa									
17	John Huff	M	1	W	School			Iowa									
18	Mary Huff	F	1	W	School			Iowa									
19	John Huff	M	1	W	School			Iowa									
20	Mary Huff	F	1	W	School			Iowa									
21	John Huff	M	1	W	School			Iowa									
22	Mary Huff	F	1	W	School			Iowa									
23	John Huff	M	1	W	School			Iowa									
24	Mary Huff	F	1	W	School			Iowa									
25	John Huff	M	1	W	School			Iowa									
26	Mary Huff	F	1	W	School			Iowa									
27	John Huff	M	1	W	School			Iowa									
28	Mary Huff	F	1	W	School			Iowa									
29	John Huff	M	1	W	School			Iowa									
30	Mary Huff	F	1	W	School			Iowa									
31	John Huff	M	1	W	School			Iowa									
32	Mary Huff	F	1	W	School			Iowa									
33	John Huff	M	1	W	School			Iowa									
34	Mary Huff	F	1	W	School			Iowa									
35	John Huff	M	1	W	School			Iowa									
36	Mary Huff	F	1	W	School			Iowa									
37	John Huff	M	1	W	School			Iowa									
38	Mary Huff	F	1	W	School			Iowa									
39	John Huff	M	1	W	School			Iowa									
40	Mary Huff	F	1	W	School			Iowa									
41	John Huff	M	1	W	School			Iowa									
42	Mary Huff	F	1	W	School			Iowa									
43	John Huff	M	1	W	School			Iowa									
44	Mary Huff	F	1	W	School			Iowa									
45	John Huff	M	1	W	School			Iowa									
46	Mary Huff	F	1	W	School			Iowa									
47	John Huff	M	1	W	School			Iowa									
48	Mary Huff	F	1	W	School			Iowa									
49	John Huff	M	1	W	School			Iowa									
50	Mary Huff	F	1	W	School			Iowa									
51	John Huff	M	1	W	School			Iowa									
52	Mary Huff	F	1	W	School			Iowa									
53	John Huff	M	1	W	School			Iowa									
54	Mary Huff	F	1	W	School			Iowa									
55	John Huff	M	1	W	School			Iowa									
56	Mary Huff	F	1	W	School			Iowa									
57	John Huff	M	1	W	School			Iowa									
58	Mary Huff	F	1	W	School			Iowa									
59	John Huff	M	1	W	School			Iowa									
60	Mary Huff	F	1	W	School			Iowa									
61	John Huff	M	1	W	School			Iowa									
62	Mary Huff	F	1	W	School			Iowa									
63	John Huff	M	1	W	School			Iowa									
64	Mary Huff	F	1	W	School			Iowa									
65	John Huff	M	1	W	School			Iowa									
66	Mary Huff	F	1	W	School			Iowa									
67	John Huff	M	1	W	School			Iowa									
68	Mary Huff	F	1	W	School			Iowa									
69	John Huff	M	1	W	School			Iowa									
70	Mary Huff	F	1	W	School			Iowa									
71	John Huff	M	1	W	School			Iowa									
72	Mary Huff	F	1	W	School			Iowa									
73	John Huff	M	1	W	School			Iowa									
74	Mary Huff	F	1	W	School			Iowa									
75	John Huff	M	1	W	School			Iowa									
76	Mary Huff	F	1	W	School			Iowa									
77	John Huff	M	1	W	School			Iowa									
78	Mary Huff	F	1	W	School			Iowa									
79	John Huff	M	1	W	School			Iowa									
80	Mary Huff	F	1	W	School			Iowa									
81	John Huff	M	1	W	School			Iowa									
82	Mary Huff	F	1	W	School			Iowa									
83	John Huff	M	1	W	School			Iowa									
84	Mary Huff	F	1	W	School			Iowa									
85	John Huff	M	1	W	School			Iowa									
86	Mary Huff	F	1	W	School			Iowa									
87	John Huff	M	1	W	School			Iowa									
88	Mary Huff	F	1	W	School			Iowa									
89	John Huff	M	1	W	School			Iowa									
90	Mary Huff	F	1	W	School			Iowa									
91	John Huff	M	1	W	School			Iowa									
92	Mary Huff	F	1	W	School			Iowa									
93	John Huff	M	1	W	School			Iowa									
94	Mary Huff	F	1	W	School			Iowa									
95	John Huff	M	1	W	School			Iowa									
96	Mary Huff	F	1	W	School			Iowa									
97	John Huff	M	1	W	School			Iowa									
98	Mary Huff	F	1	W	School			Iowa									
99	John Huff	M	1	W	School			Iowa									
100	Mary Huff	F	1	W	School			Iowa									

1870 Census of Iowa

Elizabeth, Eliza Ann, George Wesley, and Jacob Bombar were still living in Allamakee County, Iowa in 1880.

Compiled by

Dale O. Milloy

27 March 1988

List Of Documentary Proof:

Benjamin & Mary Huff:

	Document	Remarks	Address No.
1.	Marriage certificate	15 February 1847 Pike Co., Ohio	1
2.	Will of Thomas Huff 3rd	20 October 1841 will book No. 1	1
3.	Land deed Section 21	27 June 1856 Volume 14, page 545	2
4.	Will of David Rickenbach	3 December 1864 will book 1, p. 456	1
5.	Marriage record George W. Huff	20 December 1887 marriage book No. 1, p. 69	3
6.	U.S. Census reports	1850, 1860, & 1870 microfilm	4

List Of Documentary Proof:

Address No.	Address
1.	Clerk of Probate Judge 100 E 2nd Street, Waverly, OH 45690-1399
2.	County Recorder's Office 100 E 2nd Street, Waverly, OH 45690-1399
3.	Clerk Of District Court P.O.Box 248, Waukon, IA 52172-0248
4.	Any large city public library that has microfilm reading room.

Descendants Of Benjamin & Mary Huff:John Thomas Huff:

Read chapter 14.

Elizabeth Huff -- (called Aunt Lybia):

She was born on 26 May 1850 in Beaver Twp. of Pike Co., Ohio. She passed away on 24 Dec 1938 at Martinsburg, NE. She lived for 86 years, 6 months, 28 days. She married a Mr. Jacob Bombar, the date & place unknown. He went by the name of (Uncle Jake). They had six children and their names were Joe, Jim, Guy, George, Maggie, & Mary Bombar.

Elizabeth & Jacob lived in Allamakee for some years after 1887 when the Bombar family moved to a farm near Martinsburg, NE Where Jacob and Elizabeth lived out the rest of their lives.

Eliza Ann Huff:

She was born in the year of 1853 in Beaver Twp. of Pike Co., Ohio. The date and place of her death are unknown. Eliza Ann's parents moved to Post Twp. of Allamakee County, Iowa when she was about 3 years old. She attended school and grew into womanhood in Allamakee County, Iowa. When her father passed away in 1872, she was at the age of 19 when she went to live with her oldest sister Elizabeth and Jacob Bombar in Allamakee County. Eliza Ann married a Mr. L. Robinson. The date & place are unknown. They went to live in Minnesota which may be near Owatonna or Braiaerd, MN. They had a family of several children. There is very little known about her life.

Susan A. Huff:

Susan A. Huff was born on 24 Jan 1856 in Portsmouth, Ohio. She passed away on 17 February 1937 at Martinsburg, NE. She lived for 81 years, 0 Months, 24 days. Susan was around one year old when the family moved to Allamakee County, Iowa at Post Twp. She attended school and grew into womanhood in Allamakee County.

After her father Benjamin Huff died around 1872, Susan A. was around 16 years old. Susan A., her sister Abigail Huff, & her brother John Thomas Huff moved to a farm in Coldwater Twp., in Butler County, IA.

Form 243-7

STATE OF NEBRASKA
DEPARTMENT OF HEALTH
Division of Vital Statistics

Do not write in this space

J10807

1. PLACE OF DEATH
County Dixon
Township Galena
City _____ No. _____ Street _____

Length of residence in city or town where death occurred 69 mo. da. How long in U. S. if of foreign birth yr. mo. da.

2. FULL NAME Mrs. Elizabeth Bombar

1a. Residence: State Nebr. City Dixon City Martinsburg No. _____ Street _____

PERSONAL AND STATISTICAL PARTICULARS

3. SEX Female 4. COLOR OR RACE White 5. SINGLE (write the word) Widow
Married
Widowed
Divorced

6a. If married, widowed or divorced
HUSBAND or WIFE of Jacob Bombar

6. DATE OF BIRTH (mo.) May (day) 26 (year) 1859

7. Age Years 79 Months 6 Days 28 If less than 1 day
Hrs. _____ or Min. _____

8. Trade, profession or particular kind of work done, as spinner, sawyer, bookkeeper, etc. Housewife

9. Industry or business in which work was done as silk mill, saw mill, bank, etc. _____

10. Date deceased last work at this occupation (month and year) _____ Total time (years) _____ spent in this occupation _____

11. Birthplace City or Town _____ and State or Country Ohio

12. Name of Father Josh Huff

13. Birthplace of Father City or Town _____ and State or Country Indiana

14. Maiden name of Mother Mukerem

15. Birthplace of Mother City or Town _____ and State or Country Indiana

16. INFORMANT (Address) Mar 13 Bombar
Martinsburg Nebr

17. BURIAL, CREMATION, or REMOVAL Place Martinsburg Date Dec 27 1938

18. UNDERTAKER (Address) Don O. Mohr
Don O. Mohr

19. Filled JAN 9 1939 Registrar.

21. DATE OF DEATH Dec - 24 1938

22. I HEREBY CERTIFY, That I attended deceased from Dec 28 1938 to Dec 24 1938
I last saw her alive on Dec 24 1938 death is said to have occurred on the date stated above, at 11:15 PM M.
The principal cause of death and related causes of importance in order of onset were as follows: Acute gastritis Dec 24/38
gastrointestinal fungus Her husband
stones and inflammation for years.

Contributory causes of importance not related to principal cause: Benignity
Myocardial stenosis

Name of operation _____ Date of _____

What test confirmed diagnosis? _____ Was there an autopsy? no

23. If death was due to external causes (violence) fill in also the following: Accident, suicide or homicide? no Date of _____ 1938

Where did injury occur? no
(Specify city or town, county and state)

Specify whether injury occurred in industry, in home, or in public place.

Manner of injury _____

Nature of injury _____

24. Was disease or injury in any way relating to occupation of deceased? no

If so, specify _____
(Signed) E. E. Bray M. D.
(Address) Ponca Nebr

Form 243 STATE OF NEBRASKA
Bureau of Health—Division of Vital Statistics
CERTIFICATE OF DEATH

Do not write in this space
H 1990

1. PLACE OF DEATH
County Dixon
Township Galena
City Marionburg No. _____ Street _____
Length of residence in city or town where death occurred _____ yr. _____ mo. _____ da. How long in U. S. if of foreign birth _____ yr. _____ mo. _____ da.

2. FULL NAME Susan Bradburn
Residence Marionburg Neb

PERSONAL AND STATISTICAL PARTICULARS

3. SEX Female 4. COLOR or RACE White 5. Single (Write the word) Married
Widowed
Divorced

6. DATE OF BIRTH (mo.) Jan (day) 24 (yr.) 1862
7. Age Years _____ Months _____ Days _____ If less than 1 day
77 — — 24 Hrs. _____ or Min. _____

8. Trade, profession, or particular kind of work done, as spinner, sawyer, bookkeeper, etc. Housewife
9. Industry or business in which work was done, as silk mill, saw mill, bank, etc.
10. Date deceased last worked at this occupation (month and year) 1936
11. Total time (years) spent in this occupation _____

12. Birthplace {City or town and State or country} Paris, Missouri
13. Name of Father Doug Huffs
14. Birthplace of Father {City or town and State or country} Virginia
15. Maiden name of Mother Mary Rickards
16. Birthplace of Mother {City or town and State or country} Tex. Texas
17. INFORMANT Mrs. Elizabeth Bradburn (Address) Marionburg
18. BURIAL, CREMATION, OR REMOVAL
Place Marionburg Neb Date 2/19/37
19. UNDERTAKER Travis Funeral Home (Address) Marionburg
20. Filed Mar 5, 1937 Verma A. Palmer Registrar.

MEDICAL CERTIFICATE OF DEATH

21. DATE OF DEATH Feb. 17, 1937
22. I HEREBY CERTIFY, That I attended deceased from Feb. 7, 1937, to Feb. 17, 1937
I last saw HER alive on Feb. 14, 1936; death is said to have occurred on the date stated above, at 7 9 M.
The principal cause of death and related causes of importance in order of onset were as follows:
Pneumonia Feb 10/37
Contributory causes of importance not related to principal causes:
Arterial degeneration
Name of operation None Date of _____
What test confirmed diagnosis Microscopic there an autopsy? _____
23. If death was due to external causes (violence) fill in also the following:
Accident, suicide, or homicide? _____ Date of injury _____, 19____
Where did injury occur? _____ (Specify city or town, county, and State)
Specify whether injury occurred in industry, in home, or in public place
Manner of injury _____
Nature of injury _____
24. Was disease or injury in any way related to occupation of deceased? No
If so, specify _____
(Signed) R. E. Bray M. D.
(Address) Marionburg, Mo.

The Iowa State Census of 1880 lists Thomas Huff, Susan A. Huff, and Abigail Huff living on a farm in Coldwater Twp. John Thomas Huff raised his two younger sisters between the years of 1872 to 1894.

Susan A. Huff married a Mr. Alfons Bradburn in the year 1894. The place and date of marriage are unknown. He filed for a government land claim in Burnett County, WI and the family moved there in the spring of 1902 where they lived until the death of Alfons Bradburn in 1911. Susan then moved to Martinsburg, NE to live with her sister Elizabeth (Huff) Bombar, where she lived out the rest of her life.

As the story goes Alfons Bradburn was a fiddler, and he played at many dance halls for his living. Some place along the way he was converted, and he gave up playing the fiddle in the dance halls.

According to her death Certificate, her husband's name was Alfnd Bradburn. Alfnd could not be found in a name dictionary. The closest name found was Alfons. This is the most likely first name to fit the spelling on the death certificate.

Abigail Huff:

Abigail was born on 29 April 1858 in Post Twp. of Allamakee County, Iowa where she grew up, and attended school near Postville, Iowa.

Around the year 1872 her father Benjamin Huff passed away, She was 14 years old. Abigail, her sister Susan A. Huff, and her oldest brother John Thomas Huff moved to a farm in Coldwater Twp. in Butler County, Iowa. The Iowa State Census Report of 1880 listed a Thomas Huff, Susan A Huff, and Abigail Huff living on a farm in Coldwater Twp. in Butler County, Iowa. The farm is about four miles West of Greene, Iowa. John T. Huff raised his two younger sisters from 1872 to 1894.

On 24 December 1894 Abigail married a Mr. Alex Miller at Mason City, Iowa. They had two daughters which were named Callie and Cecil. Later Abigail & Alex converted to the United Brethren Church.

The family moved to Beatric in Gage County, Nebraska around 15 February 1900. On 14 December 1906 Cecil passed away. On 1 April 1907 the family moved to Coss County, near the town of Elmwood, NE. They joined the Methodist Church of Elmwood where Abigail was a member in good standing at the time of her death.

Abigail lifelong ambition was to exemplify her Christ in her own life. She was naturally religious especially finding satisfaction singing many of the old religious hymns. She also found much satisfaction during the years of her strength in helping the

George W. Huff 1st

1. Full Name of Person	2. Date of Birth	3. Place of Birth	4. Father's Name	5. Mother's Name	6. No. of Children
George W. Huff 1st	1800	Massachusetts	George W. Huff	Elizabeth	10
Elizabeth	1800	Massachusetts	George W. Huff	Elizabeth	10
John	1800	Massachusetts	George W. Huff	Elizabeth	10
Mary	1800	Massachusetts	George W. Huff	Elizabeth	10
William	1800	Massachusetts	George W. Huff	Elizabeth	10
James	1800	Massachusetts	George W. Huff	Elizabeth	10
Robert	1800	Massachusetts	George W. Huff	Elizabeth	10
Thomas	1800	Massachusetts	George W. Huff	Elizabeth	10
Charles	1800	Massachusetts	George W. Huff	Elizabeth	10
Henry	1800	Massachusetts	George W. Huff	Elizabeth	10

George W. Huff 1st

1. Full Name of Person	2. Date of Birth	3. Place of Birth	4. Father's Name	5. Mother's Name	6. No. of Children
George W. Huff 1st	1800	Massachusetts	George W. Huff	Elizabeth	10
Elizabeth	1800	Massachusetts	George W. Huff	Elizabeth	10
John	1800	Massachusetts	George W. Huff	Elizabeth	10
Mary	1800	Massachusetts	George W. Huff	Elizabeth	10
William	1800	Massachusetts	George W. Huff	Elizabeth	10
James	1800	Massachusetts	George W. Huff	Elizabeth	10
Robert	1800	Massachusetts	George W. Huff	Elizabeth	10
Thomas	1800	Massachusetts	George W. Huff	Elizabeth	10
Charles	1800	Massachusetts	George W. Huff	Elizabeth	10
Henry	1800	Massachusetts	George W. Huff	Elizabeth	10

Marriage Record of George W. Huff 1st.

Form 218

CERTIFICATE OF DEATH

STATE OF NEBRASKA

DEPARTMENT OF PUBLIC WELFARE

1 PLACE OF DEATH *Dixon*
County *Galena*
Township *Galena*
City *Galena*

State *Nebraska* Registered No. *5861*
or Village *Martinsburg*

2 FULL NAME *George Wesley Huff*
If death occurred in a hospital or institution give its name (instead of street and number)

3 SEX *Male* 4 Color of hair *White* 5 Single, Married, Widowed, or Divorced *Married*
6a If Married, Widowed, or Divorced, name of (or) wife *Mrs. Cynthia Huff*
7 DATE OF BIRTH *Febr-1-1926*
8 AGE *62* 9 *4* 10 *15*
11 OCCUPATION OF DECEASED
(a) Trade, profession, or particular kind of work *Farmer*
(b) General nature of industry, business, or establishment in which engaged
12 NAME OF EMPLOYER
13 BIRTHPLACE (City or town) (State or country) *Iowa*
14 NAME OF FATHER *Benjamin Huff*
15 BIRTHPLACE OF FATHER (City or town) (State or country) *Ohio*
16 MAIDEN NAME OF MOTHER *Mary Richard*
17 BIRTHPLACE OF MOTHER (City or town) (State or country) *Ohio*
18 Informant *Wm. Cynthia Huff*
(Address) *Martinsburg Neb*
19 Prior to Filed *12-31-26*
Registrar

14 DATE OF DEATH (Month, day, year) *June-16-26*
15 (a) (b) (c) (d) (e) (f) (g) (h) (i) (j) (k) (l) (m) (n) (o) (p) (q) (r) (s) (t) (u) (v) (w) (x) (y) (z)
16 (a) (b) (c) (d) (e) (f) (g) (h) (i) (j) (k) (l) (m) (n) (o) (p) (q) (r) (s) (t) (u) (v) (w) (x) (y) (z)
17 (a) (b) (c) (d) (e) (f) (g) (h) (i) (j) (k) (l) (m) (n) (o) (p) (q) (r) (s) (t) (u) (v) (w) (x) (y) (z)
18 (a) (b) (c) (d) (e) (f) (g) (h) (i) (j) (k) (l) (m) (n) (o) (p) (q) (r) (s) (t) (u) (v) (w) (x) (y) (z)
19 (a) (b) (c) (d) (e) (f) (g) (h) (i) (j) (k) (l) (m) (n) (o) (p) (q) (r) (s) (t) (u) (v) (w) (x) (y) (z)
20 (a) (b) (c) (d) (e) (f) (g) (h) (i) (j) (k) (l) (m) (n) (o) (p) (q) (r) (s) (t) (u) (v) (w) (x) (y) (z)

Martinsburg

Eastern Nebraska

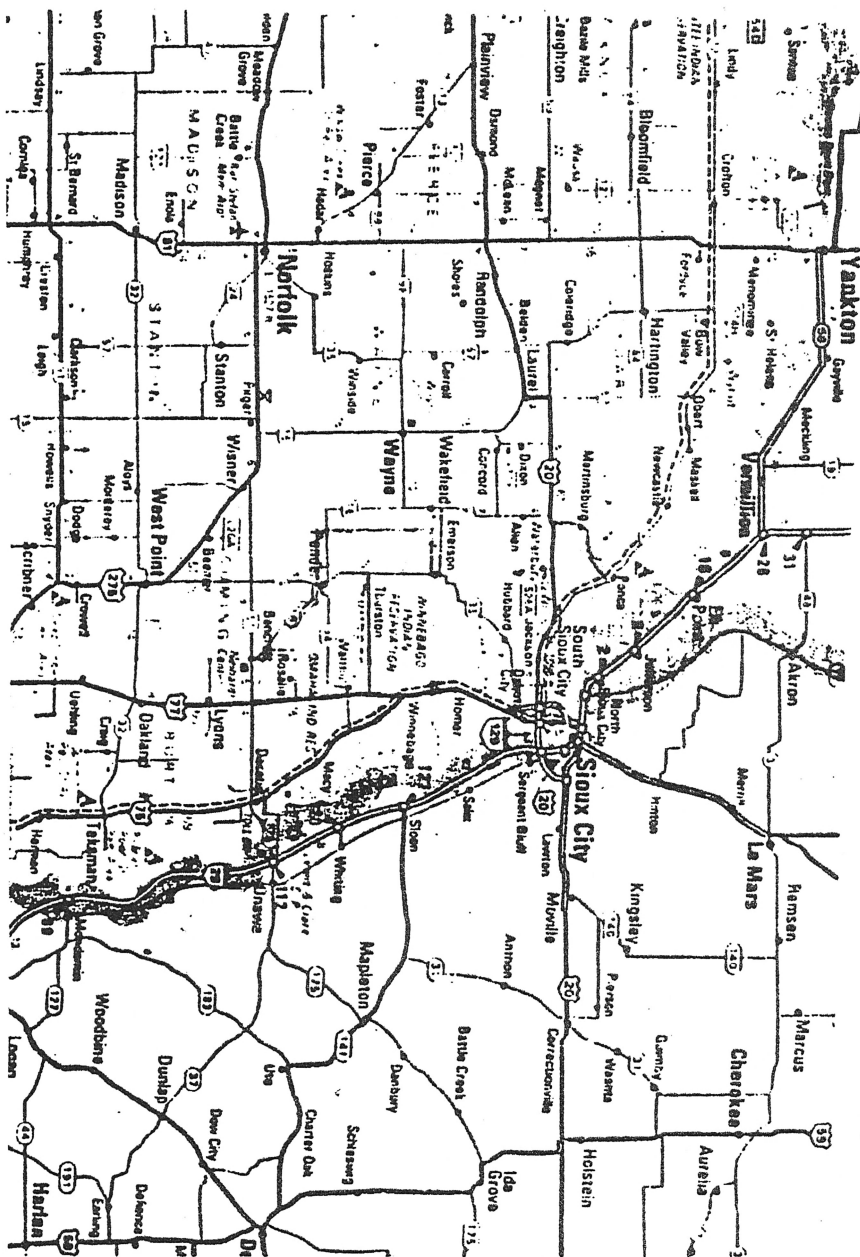

SCHEDULE I. Free Inhabitants of Pike County, Ohio, on the 1st day of June, 1850.

of Ohio enumerated by me, on the 1st day of June, 1850.

Dwelling-house numbered in the order of visitation.	Family numbered in the order of visitation.	The Name of every Person whose usual place of abode on the first day of June, 1850, was in this family.	Sex and Color.			Profession, Occupation, or Trade of each Male Person over 15 years of age.	Value of Real Estate owned.	Place of Birth, Naming the State, Territory, or Country.	Married within the year.	Attended School within the year.	Persons over 20 years of age who cannot read & write.	Whether deaf and dumb, blind, insane, idiotic, pauper, or convict.
			Male	Female	Color.							
1	1	Voluntine Olsen	17	M	W	Farmer		Germany				
2	2	Michael "	13	M				Germany				
3	3	Barth "	10	F				Germany				
4	4	John "	5	M				Prussia				
5	5	John Prunkner	18	M		Farmer	100	Prussia				
6	6	Mary "	12	F				Prussia				
7	7	Alfred "	11	F				Prussia				
8	8	John Prunkner	20	M		Farmer		Prussia				
9	9	Henry Prunkner	10	F				Prussia				
10	10	Mary "	15	F				Prussia				
11	11	Grace "	12	M		Farmer		Prussia				
12	12	Prunkner, Henry	20	M		Farmer	125	Prussia				
13	13	Mary "	21	F				Prussia				
14	14	John "	2	M				Prussia				
15	15	Elizabeth "	17	F				Prussia				
16	16	Joseph Prunkner	18	M		Farmer	400	Prussia				

1850 Pike County of Ohio in Beaver twp.

sick and needy. She was always a quite home-loving lady known best and loved most by her own family and immediate friends.

Abigail passed away on 29 October 1934 at Elmwood, NE. She lived for 76 years, 6 months, 0 days. Abigail was buried in the local cemetery near Elmwood, NE. Most of the above information was taken out of the text of Abigail's obituary in the Elmwood News Paper. The 1860 and 1870 U.S. IA Census confirmed she was born in the year 1858 in Post Twp. Allamakee County, Iowa.

George Wesley Huff 1st:

George was the youngest member of the Huff family. He was born on 1 February 1862 in Post Twp., Allamakee County, Iowa where he grew up and attended school. In 1872, after his father's death, he was 10 years old when he went to live with his oldest sister Elizabeth, and Jacob Bombar in Allamakee County, Iowa.

George W. Huff 1st was married to Cynthia Patterson on 20 December 1887 in Allamakee County, Iowa.

George & Cynthia moved with Jacob & Elizabeth Bombar to Martinsburg, NE where they lived out the rest of their lives. They did not have any children. George Wesley Huff passed away on 16 June 1926 at Martinsburg, NE. He lived for 64 years, 4 months, 15 days.

A search was made for a death certificate for Cynthia Huff, but none was found for the Martinsburg area. So it means that Cynthia Huff moved away from the Martinsburg area after the death of her husband George Wesley Huff.

If you compare several of the birth dates on the Death Certificates with the birth dates in this text you will notice there are some differences in the dates. The reason for the difference is, because the family genealogist has compared the ages that were given on the 1850, 1860, and 1870 U.S. Census. At the end of this chapter I have placed a partial copy of the 1850 U.S. Census Report. On pages 16-17 & 16-18 you find the 1860 & 1870 U.S. Census Reports.